

Design:

- Precision design with a high level of run-out accuracy, finely balanced
- Hardened clamping jaws with special protection against the ingress of chips and dirt
- Very high holding torque and rotation direction independent clamping security
- Can be used for right- and left-hand running

Application:

- For the secure clamping of drill shanks
- Steplessly adjustable clamping range of 1-16 mm
- Drill chuck can also be used for light milling work

Machine:

- CNC machining centres

Scope of Supply:

- Including chuck key SW4

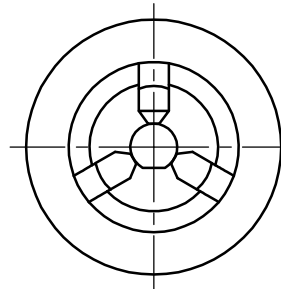
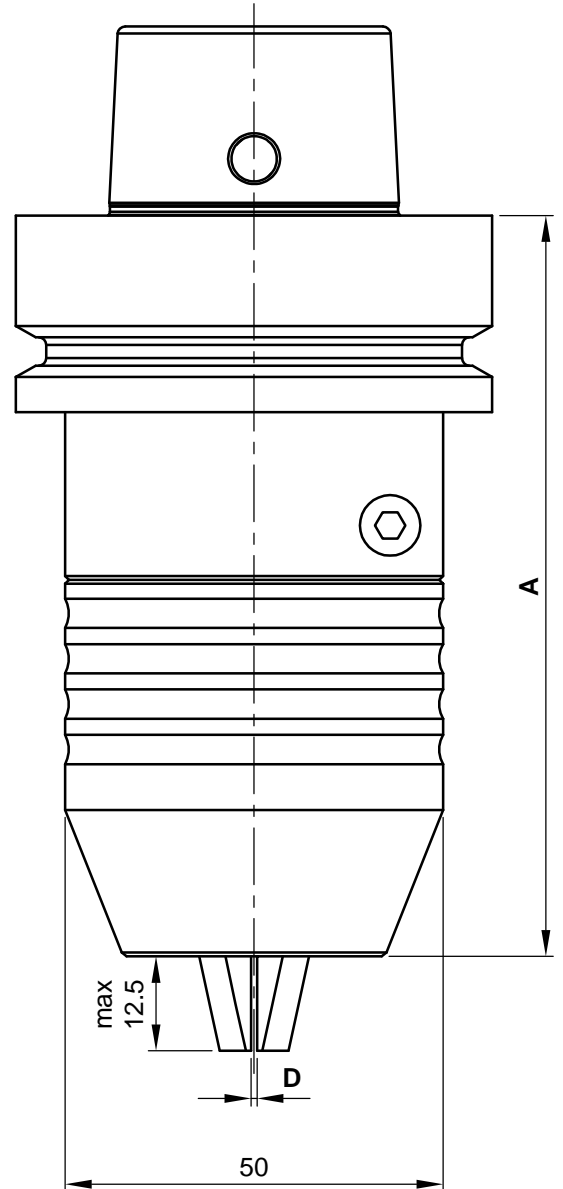
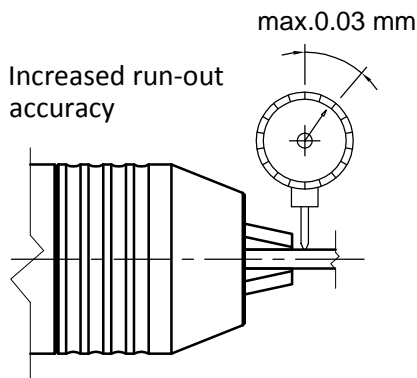
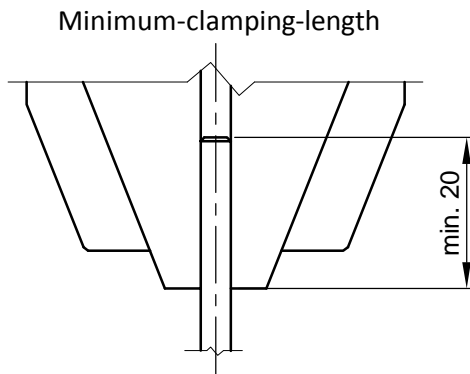

Shanks with clamping surfaces
Observe the position in accordance with the drawing

The clamping surface must lie between the clamping jaws

D	A	Ident-No.
1.0-16.0	98	C980

Spare Parts				
Description	Qty.	Dimensions	MBM	Ident-No.
T-handle Key	1	SW4	1	C980-SW4

Aigner
WERKZEUGE
e-mail:office@aigner-werkzeuge.at
www.aigner-werkzeuge.at

MBM.....Minimum Order Quantity

Blattformat: **A4** All dimensions in mm
Zchnng.-Nr. KW.49800.4 | 00

C980