

Design:

- One-piece chuck with two clamping screws for tool changes
- M10 male thread, with or without fixing flat for mounting on the machine spindle

Application:

- As the connecting and mounting piece between the machine spindle and tool shank

Machine:

- CNC machining centres
- M8/M10 Male threads for machines: Ayen, Biesse, Holzma, Mayer, Torwegge etc.
- M8/M10 Male threads with fixing flat for machines: Biesse, Busellato, Morbidelli, Torwegge etc

Assembly, Scale = 1:1

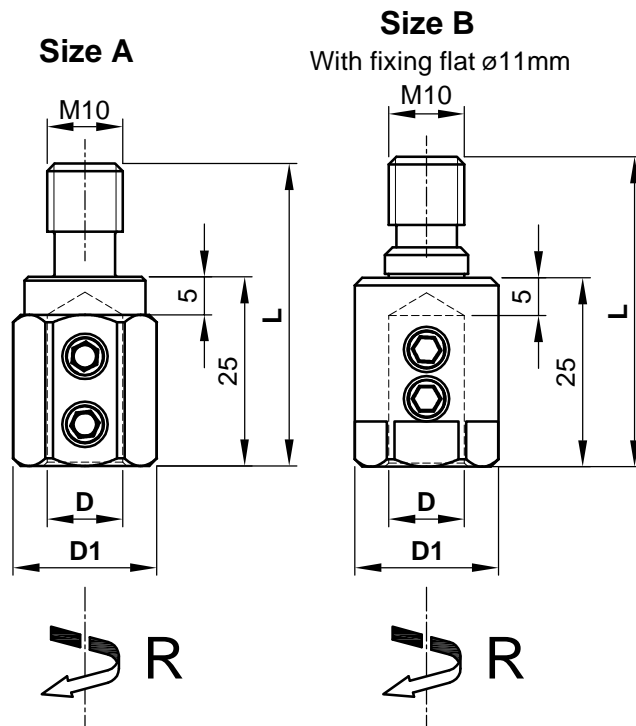
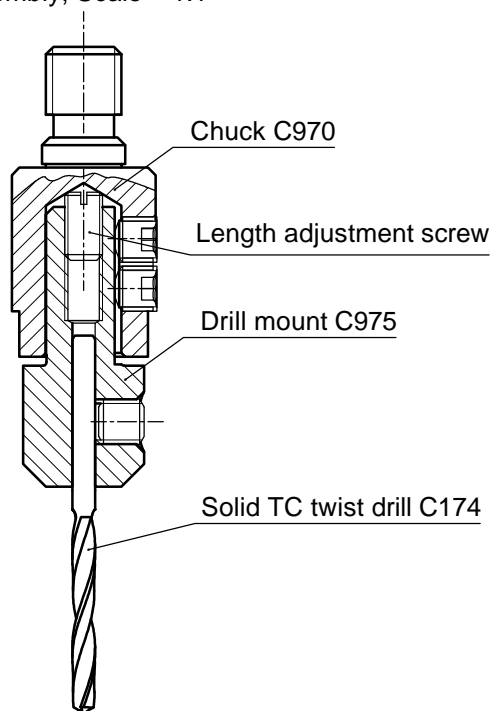

D	D1	L	S	R/L	Ident-No.
8	15.5	40	A = M10-LH (bright)	L	C970-0840LA
8	15.5	40	A = M10 (burnished)	R	C970-0840RA
10	19	40	A = M10-LH (blank)	L	C970-1040LA
10	19	40	A = M10 (burnished)	R	C970-1040RA
8	15.5	41	B = M10-LH with fixing flat	L	C970-0841LB
8	15.5	41	B = M10 with fixing flat	R	C970-0841RB
10	19	41	B = M10-LH with fixing flat	L	C970-1041LB
10	19	41	B = M10 with fixing flat	R	C970-1041RB

Spare Parts

Description	Qty.	Dimensions	MBM	Ident-No.
Grub screw for size A	2	M6x6	10	KW.45461.5
Grub screw for size B	2	M6x5	10	KW.45460.5

Aigner
WERKZEUGE

e-mail: office@aigner-werkzeuge.at
www.aigner-werkzeuge.at

G.....Size
MBM.....Minimum Order Quantity

Blattformat: **A4** All dimensions in mm
Zchnng.-Nr. KW.49700.4 | 01

C970