

Design:

- Hollow taper shank in accordance with DIN 69893
- Manufactured in hardened and tempered tool steel
- Surface bright polished or nickel plated
- For the clamping of shanks in TC and steel
- For shank tolerance h6 in accordance with EN 847-2

Application:

- Clamping of tools with shanks by means of thermal shrink-fit technology
- Very high dynamic stiffness and stability
- Ideally suited for high rotational speeds (HSC)
- Suitable for clockwise and anti-clockwise running

Machine:

- CNC machining centres

Special features:

- Optimum connection of tool and mount thanks to thermal shrink-fit technology
- High concentric running accuracy
- Suitable for high feed rates due to its robust construction
- Very smooth running due to the closed round shape
- Slim design with few interference contours for almost universal use

Application data:

- Depending on the tool fitted (up to a max. 30000 rpm)
- Max. transmissible torque for $d = 25 \text{ mm}$: $M = 500 \text{ Nm}$

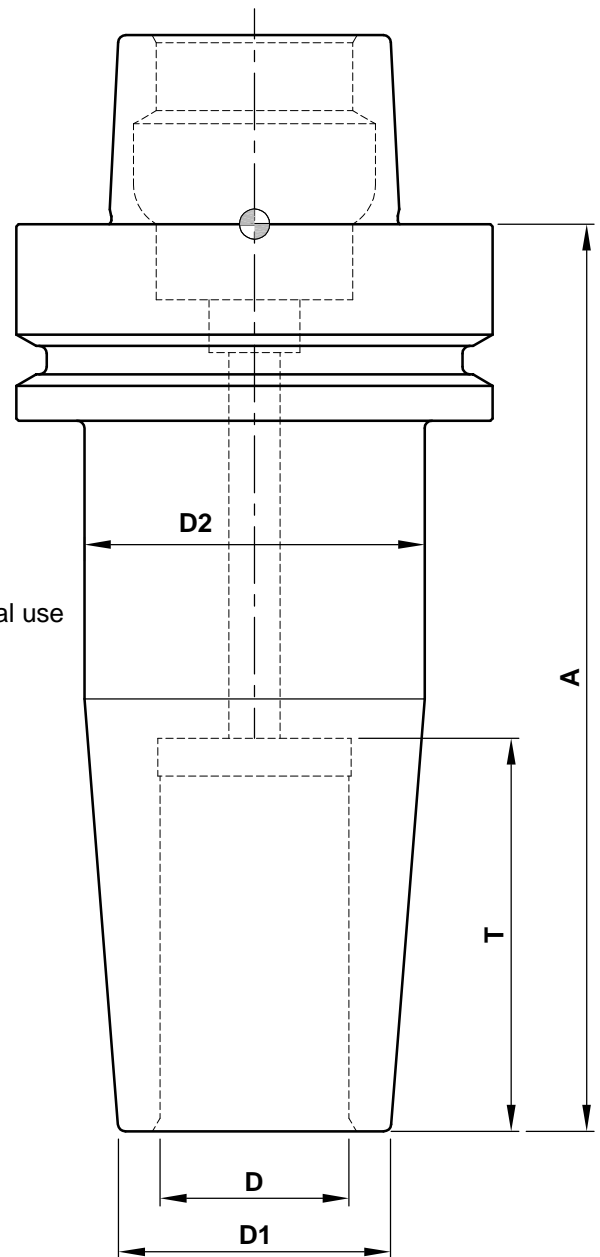

D	D1	D2	A	T	Ident-No.
6	20	27	90	36	C916-06090
8	20	27	90	36	C916-08090
10	24	32	90	41	C916-10090
12	24	32	90	46	C916-12090
16	27	34	90	44	C916-16090
20	33	42	90	51	C916-20090
25	36	45	90	52	C916-25090
6	20	27	120	36	C916-06120
8	20	27	120	36	C916-08120
10	24	32	120	41	C916-10120
12	24	32	120	46	C916-12120
16	27	34	120	44	C916-16120
20	33	42	120	51	C916-20120
25	36	45	120	52	C916-25120
20	36	43	175	47	C916-20175BN
25	36	43	175	52	C916-25175BN
20	36	43	220	47	C916-20220BN
25	36	43	220	52	C916-25220BN

Aigner
WERKZEUGE

e-mail: office@aigner-werkzeuge.at
www.aigner-werkzeuge.at

Blattformat: **A4** All dimensions in mm

Zchnng.-Nr. KW.49160.4 | 01

C916