

Design:

- Hollow taper shank in accordance with DIN 69893 Form F
- Manufactured in hardened and tempered tool steel
- Surface bright polished
- For the clamping of shanks in TC and steel
- For shaft tolerances h6 in accordance with EN 847-2

Application:

- Clamping of tools with shanks by means of exchangeable collets (C945-ER16xxx)
- Type ER16 in accordance with DIN ISO 15488
- Clamping range 1-10 mm
- Observe the minimum clamping length for the respective cutter shank (marking on the shank in accordance with EN 847-2/6)

Machine:

- CNC machining centres

Scope of supply:

- Collet chuck with clamping nut
- Without a collet (C945-ER16xxx)
- Without a ring profile wrench (KW.27593.7)

Special Features:

- Slim chuck for light drilling and milling work
- Reduce speed accordingly during drilling work

Additional Information:

- With clamped tools using collet chucks, the setting dimension A is measured with a clamping tolerance of 0.15 mm

max. overhang length (L1)
at an operating speed of 24000 rpm

SchaftØ	D	D1	L1
10	22	10	80
8	22	8	70
6	22	6	60

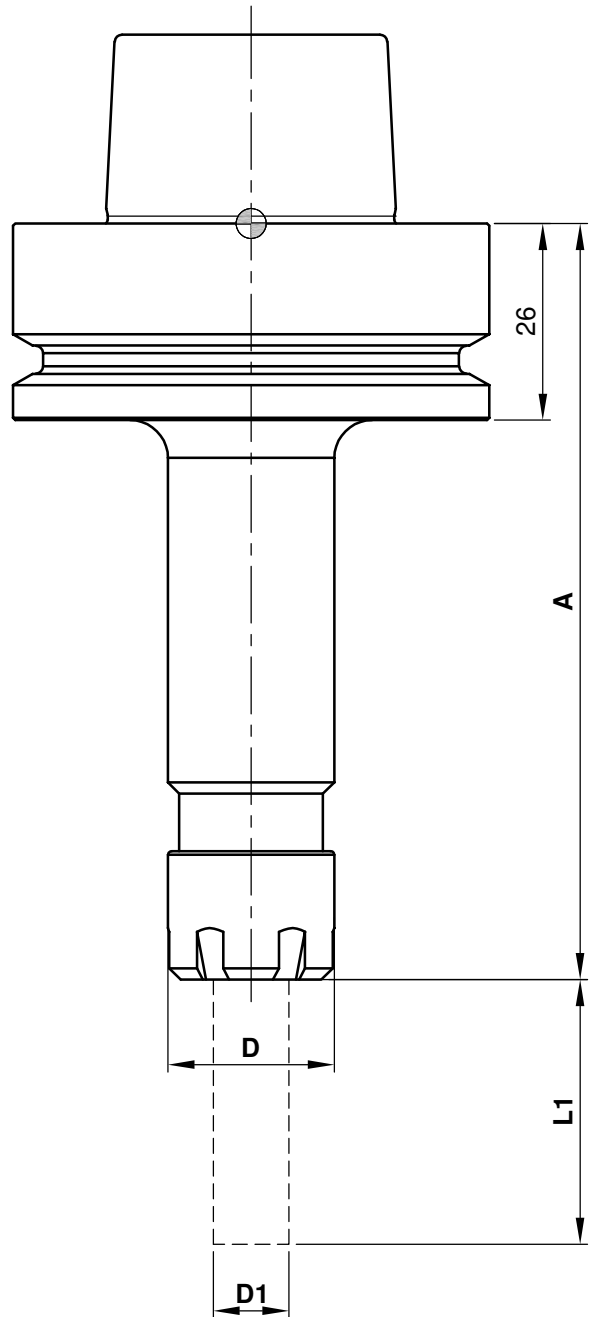

D	A	R/L	n max.	Ident-No.
22	100	R	24000	C914-ER16100R
22	130	R	24000	C914-ER16130R
22	160	R	24000	C914-ER16160R

Spare Parts				
Description	Qty.	Dimensions	MBM	Ident-No.
Ring profile wrench	1	ER16	1	KW.27593.7

 <p>e-mail:office@aigner-werkzeuge.at www.aigner-werkzeuge.at</p>	n max.....Maximum Rotational Speed (rpm)	Blattformat: A4	All dimensions in mm Zchnng.-Nr. KW.49140.4 01
		C914	