

Design:

- Hollow shank taper according to DIN 69893
- Made of quenched and tempered tool steel
- Surface polished
- For clamping carbide and steel shanks
- For shank tolerance h6 according to EN 847-2

Application:

- Clamping tools with shank using thermal shrink-fit technique
- very high dynamic rigidity and stability
- Ideal for high-speed cutting (HSC)
- Suitable for clockwise and counterclockwise rotation

Machine:

- CNC machining centers

Special features:

- Optimal connection between tool and holder via thermal shrink-fit
- High runout accuracy
- Suitable for high feed rates due to robust design
- Very smooth operation thanks to closed circular design
- Slim design with minimal interfering contours for maximum versatility

Operating data:

- According to mounted tool (up to max. 30000 U/min)
- Max. transmissible torque for $d = 25 \text{ mm}$: $M = 500 \text{ Nm}$

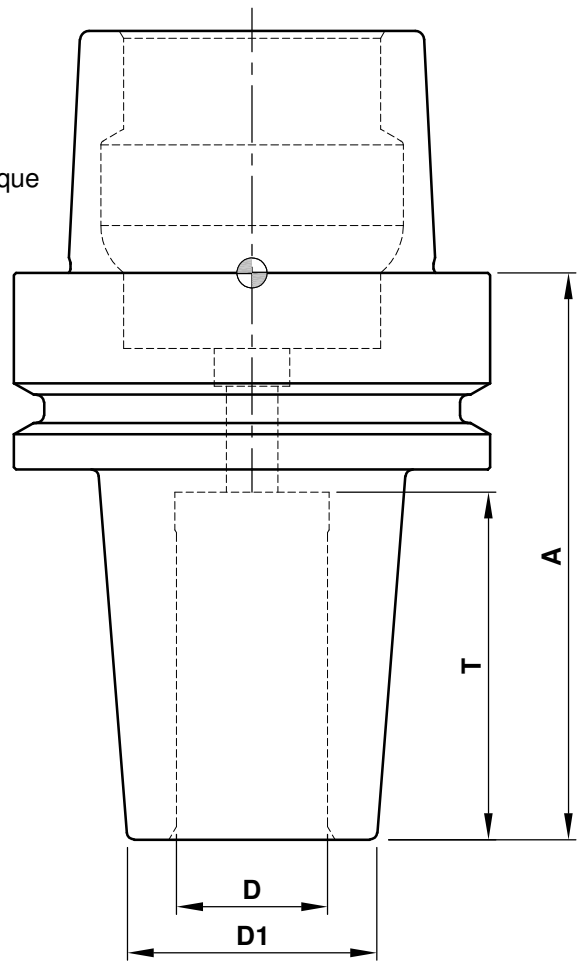

D	D1	A	T	Ident-No.
8	20	75	36	C815-0875
10	24	75	36	C815-1075
12	24	75	41	C815-1275
14	27	75	41	C815-1475
16	27	75	44	C815-1675
20	33	75	46	C815-2075
25	36	75	52	C815-2575
30	44	75	52	C815-3075

Aigner
WERKZEUGE

e-mail: office@aigner-werkzeuge.at
www.aigner-werkzeuge.at

Blattformat: **A4** all dim. in mm
Zchnng.-Nr. KW.48150.4 | 00

C815