

# HS-Tongue- and Groove-Set

C622

Cutting Material  
**HS**

Feed  
**MEC**

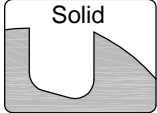

**Design:**

- Tool body in Q & T steel
- HS tipped
- 2-piece cutter set for left-hand spindle
- 2-piece cutter set for left-hand spindle

**Application:**

- For the production of floor, wall and ceiling cladding

**Workpiece material:**

- Softwood

**Machine:**

- Planing and moulding machines

**Scope of supply:**

- HS tongue and groove set
- Associated set of rings

**Special features:**

- Adjustable from 18 to 40 mm
- With tongue and groove clearance

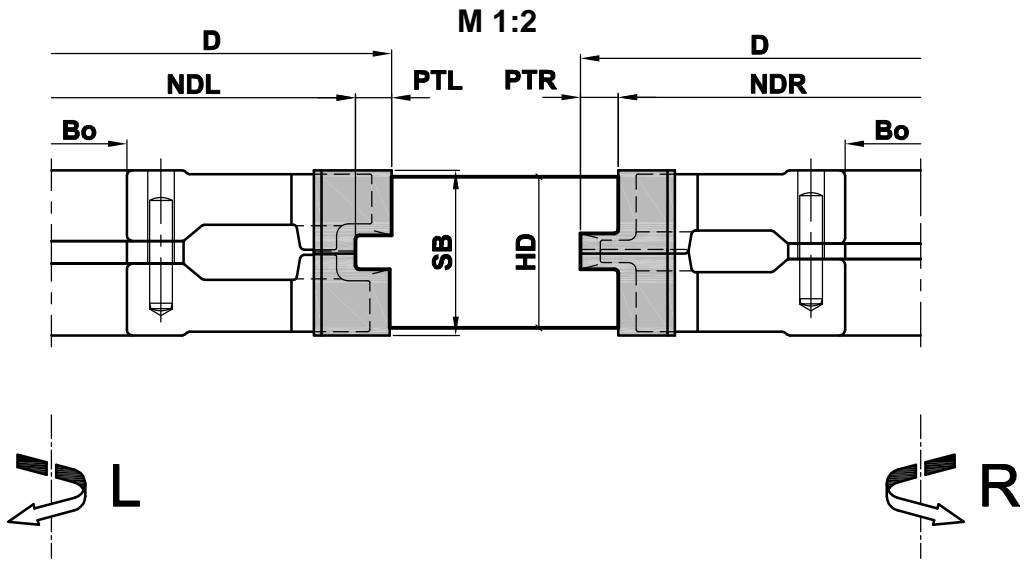
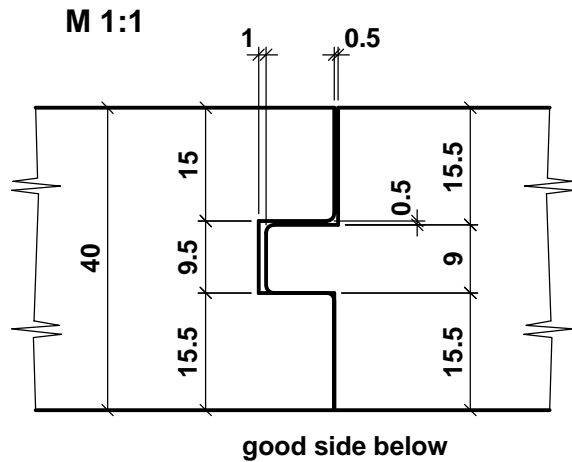
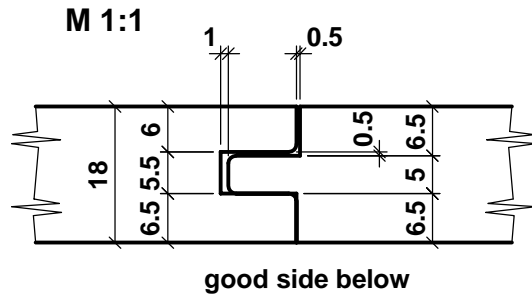

| D   | NDL | NDR | SB   | PTL | PTR | HD    | Bo | Z | R/L | n max. | Ident-No. |
|-----|-----|-----|------|-----|-----|-------|----|---|-----|--------|-----------|
| 160 | 141 | 140 | 43.7 | 9.5 | 10  | 18-40 | 40 | 4 | R/L | 9500   | C622-160  |
| 180 | 161 | 160 | 43.7 | 9.5 | 10  | 18-40 | 40 | 6 | R/L | 8500   | C622-180  |

**Aigner**  
WERKZEUGE  
e-mail: office@aigner-werkzeuge.at  
www.aigner-werkzeuge.at

n max.....Maximum Rotational Speed (rpm)  
Z.....No. of teeth

Blattformat: **A4** All dimensions in mm  
Zchnng.-Nr. KW.46220.4 | 00

C622