

# TC-Adjustable-Grooving-Cutter

C360

Cutting Material  
**TC**

Number of Teeth  
**Z2/2 V2/2**

Feed  
**MAN**

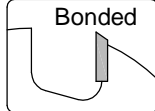

**Design:**

- Tool body in steel
- 2-piece or 3-piece adjustable via spacing rings
- Permanently TC tipped
- Bore up to max. Ø40 possible at extra cost

**Application:**

- For grooving and rebating in soft and hard woods and panel materials

**Workpiece material:**

- Solid wood and panel materials

**Machine:**

- Spindle moulders

**Scope of supply:**

- Adjustable grooving cutter
- Associated spacer set

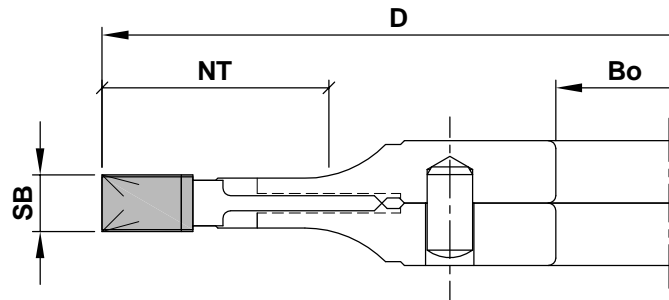

**2-piece**

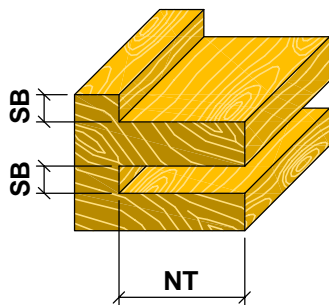
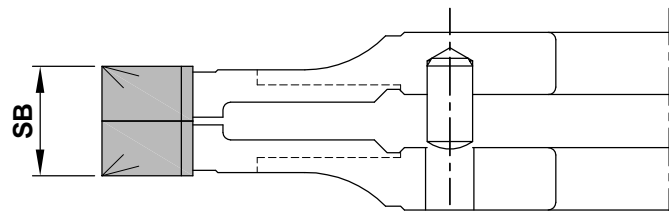

**3-piece**

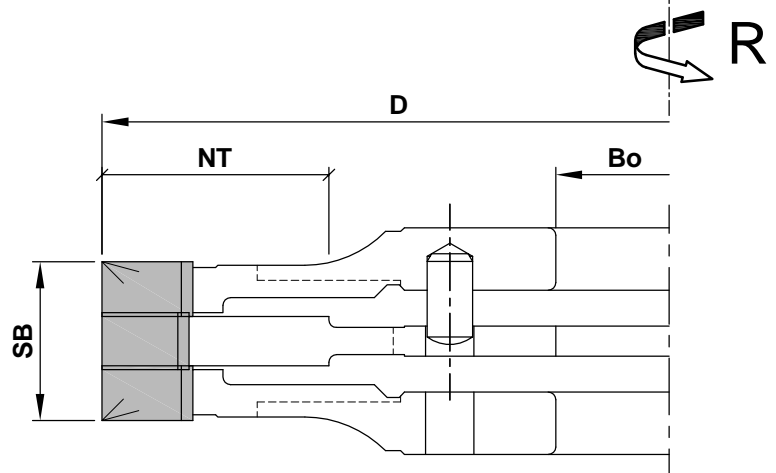

D	SB	NT	Bo	Z	V	FA	R/L	DZ	Ident-No.
150	4-7.5	30	30	2+2	2+2	2	R	5000-9000	C360-150475
150	7.5-14.5	30	30	2+2	2+2	2	R	5000-9000	C360-15075145
150	10-19.5	30	30	2+2	2+2	2	R	5000-9000	C360-15010195
150	4-7.5/8-14	30	30	2+2	2+2	3	R	5000-9000	C360-150414
150	7.5-21	30	30	2+2	2+2	3	R	5000-9000	C360-1507521
180	4-7.5	45	30	2+2	2+2	2	R	4500-7500	C360-180475
180	7.5-14.5	45	30	2+2	2+2	2	R	4500-7500	C360-18075145
180	10-19.5	45	30	2+2	2+2	2	R	4500-7500	C360-18010195
180	4-7.5/8-14	45	30	2+2	2+2	3	R	4500-7500	C360-180414
180	7.5-21	45	30	2+2	2+2	3	R	4500-7500	C360-1807521

**Aigner**  
WERKZEUGE  
e-mail: office@aigner-werkzeuge.at  
www.aigner-werkzeuge.at

Z.....No. of teeth    V.....Spur  
FA.....No. of cutters  
DZ.....Speed Range (rpm)

Blattformat: **A4** All dimensions in mm  
Zchnng.-Nr. KW.43600.4 | 01

**C360**