

WM-Adjustable-Grooving-Cutter

C306

Cutting Material
TC

Zähnezahl
Z2/2 V2/2

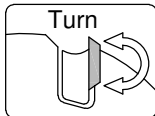

Feed
MAN

Design:

- Tool body in steel
- 2-piece or 3-piece adjustable via spacers
- TC reversible cutter
- Bore up to max. $\varnothing 40$ mm possible at extra cost

Application:

- For grooving and rebating in soft and hardwoods and panel materials, etc.

Workpiece material:

- Solid wood and panel materials

Machine:

- Spindle moulders

Scope of supply:

- Tool body including cutters
- Associated key with handle
- 1 magnetic assembly jig
- Associated spacer set

Special features:

- Specially developed clamping system for small cutting widths

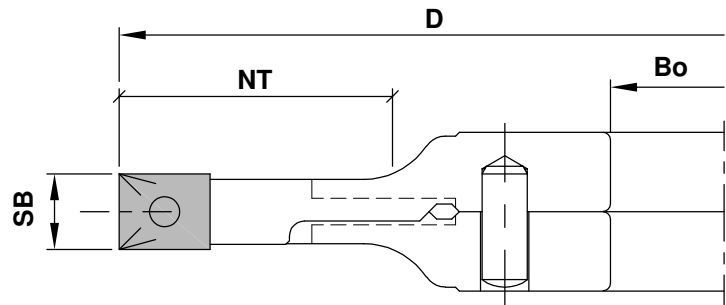

2-piece

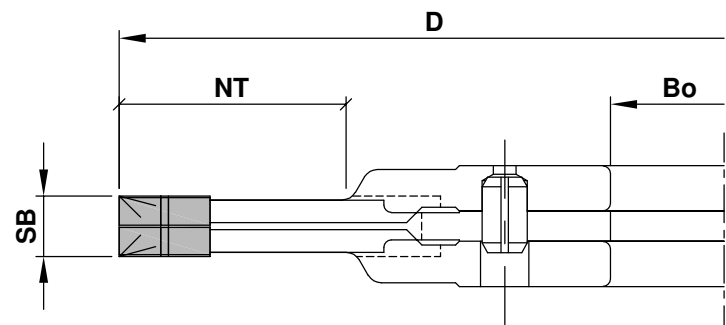
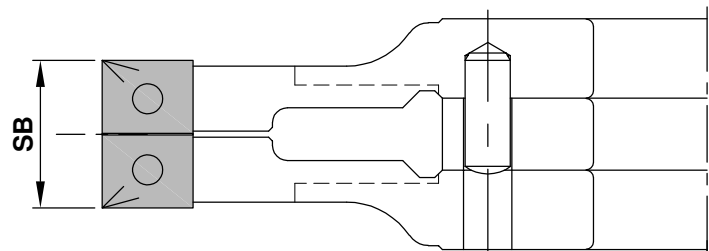

3-piece

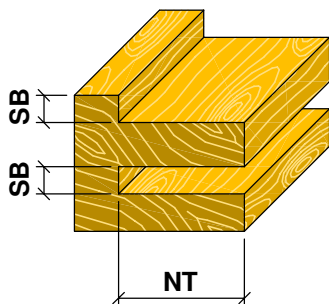
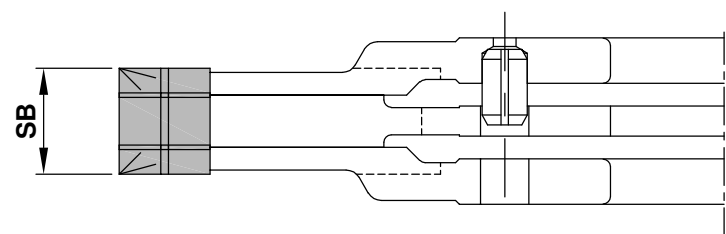

Aigner
WERKZEUGE

e-mail: office@aigner-werkzeuge.at
www.aigner-werkzeuge.at

Blattformat: **A4** All dimensions in mm

Zchnng.-Nr. KW.43060.4 | 00

C306

D	SB	NT	Bo	Z	V	FA	R/L	DZ	Ident-No.
160	4.0-7.5	30	30	2+2	2+2	2	R	4500-8000	C306-160475
180	4.0-7.5	40	30	2+2	2+2	2	R	4500-7500	C306-180475
160	8.0-15.0	37	30	2+2	2+2	2	R	4500-8000	C306-160815
180	8.0-15.0	47	30	2+2	2+2	2	R	4500-7500	C306-180815
160	10.0-19.5	35	30	2+2	2+2	2	R	4500-8000	C306-16010195
180	10.0-19.5	45	30	2+2	2+2	2	R	4500-7500	C306-18010195
160	12.5-24.0	35	30	2+2	2+2	2	R	4500-8000	C306-16012524
180	12.5-24.0	45	30	2+2	2+2	2	R	4500-7500	C306-18012524
160	4.0-14.0	30	30	2+2	2+2	3	R	4500-8000	C306-160414
180	4.0-14.0	40	30	2+2	2+2	3	R	4500-7500	C306-180414
160	8.0-22.0	37	30	2+2	2+2	3	R	4500-8000	C306-160822
180	8.0-22.0	47	30	2+2	2+2	3	R	4500-7500	C306-180822

Spare Parts

Description	Qty.	Dimensions	MBM	Ident-No.
Reversible Cutter for SB 4.0-7.5	4	3.6x12x2.5	10	WMF3.6x12x2.5/U
Reversible Cutter for SB 8.0-15.0	4	7.5x12x2.5	10	WMF7.5x12x2.5/U
Reversible Cutter for SB 10.0-19.5	4	9.6x12x1.5	10	WMF9.6x12/U
Reversible Cutter for SB 12.5-24.0	4	12x12x1.5	10	WMF12x12/U
Reversible Cutter for SB 4.0-14.0 for 3 Pieces	4	3.6x12x2.5	10	WMF3.6x12x2.5/U
Reversible Cutter for SB 4.0-14.0 Expansion P.	2	7.5x12x2.5	10	WMF7.5x12x2.5/U
Reversible Cutter for SB 8.0-22.0 for 3 Pieces	4	7.5x12x2.5	10	WMF7.5x12x2.5/U
Reversible Cutter for SB 8.0-22.0 Expansion P.	2	7.5x12x2.5	10	WMF7.5x12x2.5/U
Spur for SB 4.0-7.5	4	14x14x1.2	10	VS14x14x1.2/M
Spur for SB 8.0-24.0	4	14x14x2.0	10	VS14x14x2.0/U
Spur for SB 4.0-14.0 for 3 Pieces	4	14x14x1.2	10	VS14x14x1.2/M
Spur for SB 8.0-22.0 for 3 Pieces	4	14x14x2.0	10	VS14x14x2.0/U
Screw Main Cutter for SB 4-7.5	4	Eccentric B=3	2	KW.04766.4-3
Screw Main Cutter for SB 8-15	4	Eccentric B=5	2	KW.04766.4-5
Screw Main Cutter for SB 10-24	4	Grub Screw M6x16	10	KW.44252.5
Nut Spur for SB 4-7.5	4	Nut M4xD9.9xd8.45	10	KW.44245.5
Screw Spur for SB 4-7.5	4	Screw TSP M4x3.2	10	KW.44243.5
Screw Spur for SB 8-24	4	Countersunk Screw M6x6	10	KW.33767.4-6

Aigner
WERKZEUGE

e-mail:office@aigner-werkzeuge.at
www.aigner-werkzeuge.at

Z.....No. of teeth V.....Spurs

FA.....Number of Cutters

DZ.....Speed Range (rpm)

MBM.....Minimum Order Quantity

Blattformat: **A4** All dimensions in mm

Zchnng.-Nr. KW.43060.4 | 01

C306-1