

Cutting Material

TC

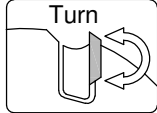

Feed

MEC

Design:

- Tool body in light alloy
- TC reversible blade with alternating axis angle
- TC positive spur R1

Application:

- Jointing, rebating and planing

Workpiece material:

- Solid wood and panel materials

Machine:

- CNC machining centres

Scope of supply:

- Tool body including cutters and grooving cutter SB5
- Associated key with handle
- Also optionally assembled and balanced (MS):
Assembled on a milling arbor
HSK-F 63 (C905-4530xx):...-F1
Assembled on a milling arbor
HSK-F 63 (C905-8030xx):...-F2

Special features:

- Highest rebate quality thanks to the TC positive spur
- "High Tech" clamping system
- The milling cutter can also be fitted turned over for left-hand rotation
- The same zero height from both sides when turning over the cutter
- Grooving cutters can also be fitted on the tool underside
- Optionally a smaller groove cutter can be fitted (with distance ring)
- Can also be used as a planing cutter

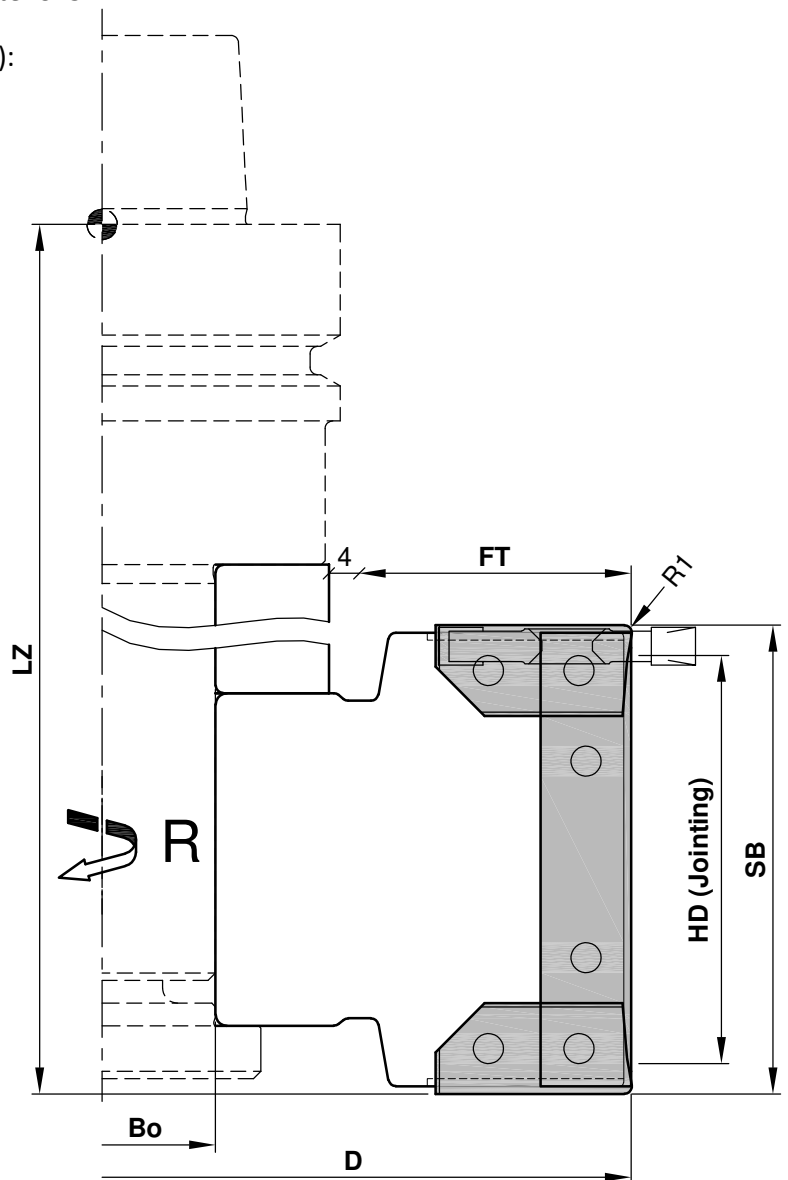

Aigner
WERKZEUGE

e-mail: office@aigner-werkzeuge.at
www.aigner-werkzeuge.at

MS.....Machine Adaptor

Blattformat: **A4** All dimensions in mm

Zchnng.-Nr. KW.42730.4 | 01

C273

D	SB	FT	HD	Bo	LZ	Z	V	R/L	n max.	Ident-No.
140	42	36	34	30		2	2+2	R/L	9300	C273-42
140	42	36	34	30	160	2	2+2	R/L	9300	C273-42-F1
140	42	36	34	30	177	2	2+2	R/L	9300	C273-42-F2
140	52	36	44	30		2	2+2	R/L	9300	C273-52
140	52	36	44	30	160	2	2+2	R/L	9300	C273-52-F1
140	52	36	44	30	177	2	2+2	R/L	9300	C273-52-F2
140	62	36	54	30		2	2+2	R/L	9300	C273-62
140	62	36	54	30	160	2	2+2	R/L	9300	C273-62-F1
140	62	36	54	30	177	2	2+2	R/L	9300	C273-62-F2
160	42	46	34	30		2	2+2	R/L	8500	C273-16042
160	42	46	34	30	160	2	2+2	R/L	8500	C273-16042-F1
160	42	46	34	30	177	2	2+2	R/L	8500	C273-16042-F2
160	52	46	44	30		2	2+2	R/L	8500	C273-16052
160	52	46	44	30	160	2	2+2	R/L	8500	C273-16052-F1
160	52	46	44	30	177	2	2+2	R/L	8500	C273-16052-F2
160	62	46	54	30		2	2+2	R/L	8500	C273-16062
160	62	46	54	30	160	2	2+2	R/L	8500	C273-16062-F1
160	62	46	54	30	177	2	2+2	R/L	8500	C273-16062-F2
180	42	56	34	30		2	2+2	R/L	7500	C273-18042
180	42	56	34	30	160	2	2+2	R/L	7500	C273-18042-F1
180	42	56	34	30	177	2	2+2	R/L	7500	C273-18042-F2
180	52	56	44	30		2	2+2	R/L	7500	C273-18052
180	52	56	44	30	160	2	2+2	R/L	7500	C273-18052-F1
180	52	56	44	30	177	2	2+2	R/L	7500	C273-18052-F2
180	62	56	54	30		2	2+2	R/L	7500	C273-18062
180	62	56	54	30	160	2	2+2	R/L	7500	C273-18062-F1
180	62	56	54	30	177	2	2+2	R/L	7500	C273-18062-F2

Spare Parts

Description	Qty.	Dimensions	MBM	Ident-No.
Reversible Cutter for SB 42	2	40x12x1.5	10	WMF40x12/U
Reversible Cutter for SB 52	2	50x12x1.5	10	WMF50x12/U
Reversible Cutter for SB 62	2	60x12x1.5	10	WMF60x12/U
Spur Top	2	26x12x2	2	PM.26085.5
Spur Bottom	2	26x12x2	2	PM.26084.5
Grooving Cutter	2	34x16x5	2	VHMSB5.0
Grooving Cutter (option)	2	34x16x4	2	VHMSB4.0
Screw Spur	4	Roundhead Screw T15 M4x8	10	KW.44236.5
Screw Grooving Cutter	2	Countersunk Screw T20 M6x10	10	KW.33767.4-10

Aigner
WERKZEUGE

e-mail:office@aigner-werkzeuge.at
www.aigner-werkzeuge.at

n max.....Maximum Rotational Speed (rpm)

Z.....No. of teeth

V.....Spur

MBM.....Minimum Order Quantity

Blattformat: **A4** All dimensions in mm

Zchnng.-Nr. KW.42730.4 | 01

C273-1