

WM-Shank Grooving Cutter for CNC

C263

Cutting Material
TC

Number of Teeth
Z 2

Feed
MEC

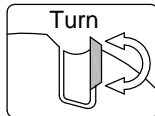

Design:

- Tool body optionally in V155 or Densimet
- Z2 + cross cutter
- TC reversible blade
- WM bore cutter
- Axially parallel cutting
- Cylindrical shank Ø20 or Ø25

Application:

- For, jointing, rebating, grooving and copy shaping

Workpiece material:

- Solid wood and panel materials

Machine:

- CNC machining centres

Scope of supply:

- Tool body including cutters
- Key with handle Torx T15
- Allen key with handle SW2.5
- Principally with a length setting screw:
For use with shrink chucks HSK-F 63 (C915)
without a length setting screw
- Also optionally assembled (and balanced) (MS):
Assembled in shrink chuck HSK-F 63 (C915): C263-...-M1
Assembled in collet chuck HSK-F 63 (C910): C263-...-M2

Special features:

- True two-tooth milling cutter

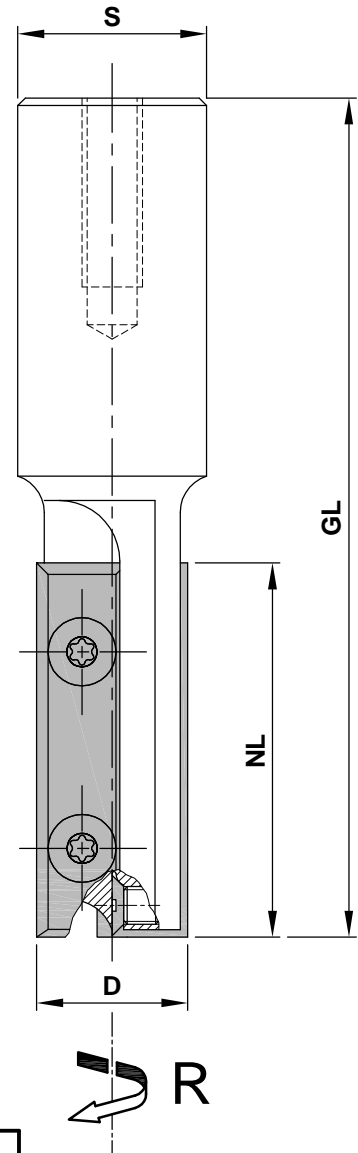

D	NL	GL	S	Z	R/L	M	n max.	Ident-No.
20	49.5	111	20	2	R	V	20000	C263-205020VR
20	49.5	111	20	2	L	V	20000	C263-205020VL
20	49.5	111	25	2	R	V	20000	C263-205025VR
20	49.5	111	25	2	L	V	20000	C263-205025VL
20	49.5	111	20	2	R	D	20000	C263-205020DR
20	49.5	111	20	2	L	D	20000	C263-205020DL
20	49.5	111	25	2	R	D	20000	C263-205025DR
20	49.5	111	25	2	L	D	20000	C263-205025DL

Spare Parts				
Description	Qty.	Dimensions	MBM	Ident-No.
Main Cutter	2	49.5x12x1.5	10	WMN49.5x12/P
Bore Cutter	1	7.6x8x1.5	10	WMF7.6x8/P
Roundhead Screw	4	M4x6 (head D9) Torx T15	10	KW.44237.5
Grub Screw	1	M5x5	10	KW.44315.5

 <p>e-mail:office@aigner-werkzeuge.at www.aigner-werkzeuge.at</p>	MS....Machine Adaptor Z....No. of teeth	Blattformat: A4 <small>All dimensions in mm</small>
	M.....Material: V....V155 D....Densimet	Zchnng.-Nr. KW.42630.4 00
n max.....Maximum Rotational Speed (rpm)	C263	
MBM.....Minimum Order Quantity		