

Cutting Material <b>DP</b>	Number of Teeth <b>Z 2</b>	Feed <b>MAN</b>
-------------------------------	-------------------------------	--------------------

**Design:**

- Tool body in steel
- No. of Teeth = 2
- Cutting elements fitted with DP (DIA)
- Bevel cutter with replaceable DP knives
- Deep chip spaces for better chip capture
- Shank fit h6

**Application:**

- Bevel cutter with ball bearing

**Workpiece Material:**

- Panel material

**Machine:**

- Portable router

**Scope of Supply:**

- Tool body including DP knives
- Handle key Torx T10
- Grooved ball bearing
- Robust twist pack with a transparent cover

**Special Features:**

- Constant diameter bevel cutter
- All knives interchangeable
- Knives can be replaced on site
- Very good chip removal

**Additional Information:**

- A torque wrench is recommended for the changing of the knives (see C986-FT1810)

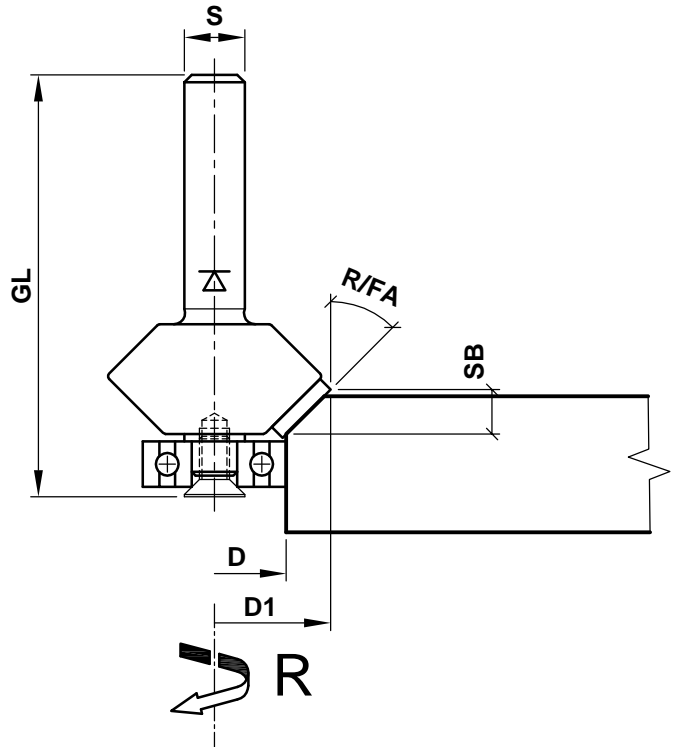

D	D1	GL	R/FA	SB	S	Z	R/L	n max.	Ident-No.
16	27.7	51.6	45°	5.9	6	2	R	24000	C166-316450606R
16	27.7	54.1	45°	5.9	8	2	R	24000	C166-316450608R
16	27.7	60.1	45°	5.9	12	2	R	24000	C166-316450612R
16	24	49.1	30°	7.8	6	2	R	24000	C166-316300806R
16	24	51.6	30°	7.8	8	2	R	24000	C166-316300808R
16	24	57.6	30°	7.8	12	2	R	24000	C166-316300812R
16	37.6	57.6	45°	11.3	8	2+2	R	22000	C166-316451108R
16	37.6	63.6	45°	11.3	12	2+2	R	22000	C166-316451112R
16	31	57.6	30°	13.9	8	2+2	R	24000	C166-316301408R
16	31	63.6	30°	13.9	12	2+2	R	24000	C166-316301412R

Spare Parts				
Description	Qty.	Dimensions	MBM	Ident-No.
Replaceable knife circumference cutter	2/4	9x8x2.5	2	KW.15766.7/B25
Clamping screw circumference cutter	2/4	Countersunk screw M3x6 T10	10	KW.15714.7
Grooved ball bearing Ø16	1	16x6x5	1	KW.52986.5
Screw for grooved ball bearing Ø16	1	Countersunk screw M4x6	10	KW.53370.5

 <p>e-mail:office@aigner-werkzeuge.at www.aigner-werkzeuge.at</p>	Z.....No. of teeth	Blattformat: <b>A4</b> <small>All dimensions in mm</small>
	n max.....Max Speed (rpm)	Zchnng.-Nr. KW.41663.4   01
MBM.....Mnimum Order Quantity	<b>C166-3</b>	