

PM-DP-Hybride Mitre Glue Joint Cutter 45° Konstantin®PRO C126-1

Cutting Material TC	Cutting Material DP	Number of Teeth Z 2	Feed MAN	Replace
-------------------------------	-------------------------------	-------------------------------	--------------------	-------------

Design:

- Basic body made of light alloy
- Z2
- HW profile knives
- Cutting elements tipped with DP (DIA)
- Drawing cut

Application:

- For producing 45° mitre joints on spindle moulders, with a trapezoidal tongue- and groove profile, for cabinet parts, claddings, etc.

Workpiece material:

- Panel materials

Machine:

- Spindle moulder
- CNC machining centers

Scope of Supply:

- Basic body incl. TC profile and DP knives
- Torx T30 handle key
- Optionally also assembled (and balanced) (MS):
Mounted on milling arbor HSK-F 63 (C905-453055): C126-1...F1

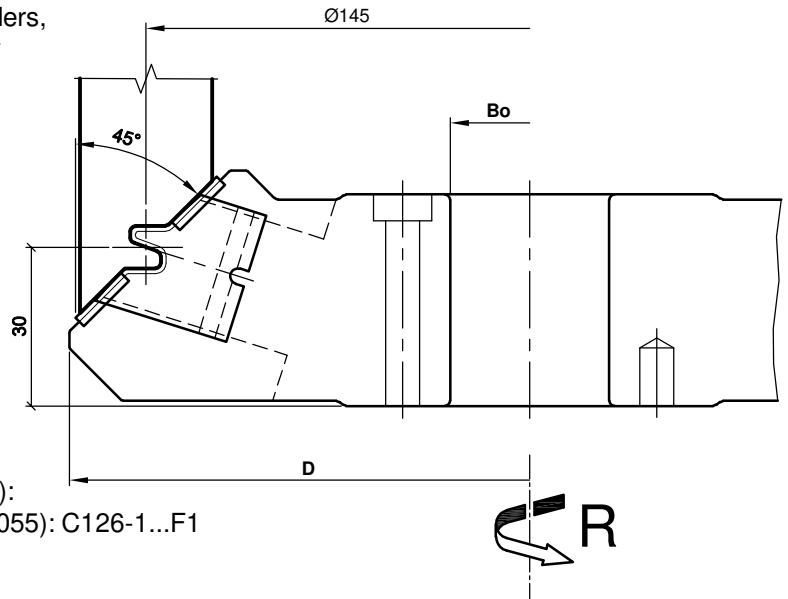

Special feature:

- Integrated stop face for easy adjustment of the profile center

Additional information:

- A torque wrench is recommended for changing the DP cutting edge (see C986-FT2210)

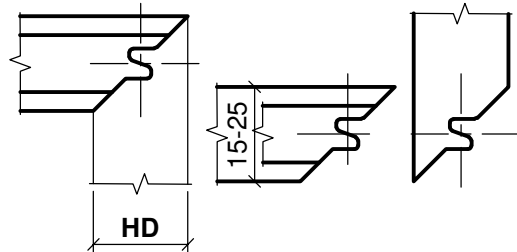

D	HD	Bo	Z	R/L	n max.	Ident-No.
174	15-25	30	2	R	8000	C126-1174
174	15-25	30	2	R	8000	C126-1174-F1
186	25-40	30	2	R	7500	C126-2186
186	25-40	30	2	R	7500	C126-2186-F1

Spare Parts						
Description	Qty.	Dimensions	MBM	Ident-No.		
TC Profile knife	2	25x24.6x2	2	PM.61814.5/U35		
DP Cutting Knife	4	14.5x11.3	2	KW.35894.7/B02		
Clamping Screw for Profile Knife	2	Cylindrical Screw M6x16 T30	10	KW.53281.5		
Clamping Screw for DP Cutting Knife	4	Plate Screw T10 M5x7.3	10	KW.34603.7		

 e-mail:office@aigner-werkzeuge.at www.aigner-werkzeuge.at	MS.....Machine Adaptor	Blattformat: A4	<small>all dim. in mm</small>
	Z.....No. of teeth	Zchnng.-Nr. KW.41261.4	00
n max.....Maximum Rotational Speed (rpm)	C126-1		
MBM.....Minimum Order Quantity			